



USED FOR SALE OR LEASE

Mobile Dental Clinic ♦ Vehicle Upgrades & New Interior Build 2024

(MHC #525C-D)

Asking Price: \$165,000 (negotiable); available for lease

Location: Katy, TX

For Additional Photos & Assistance, Contact: (619) 795-9605 or mobileclinics@aol.com

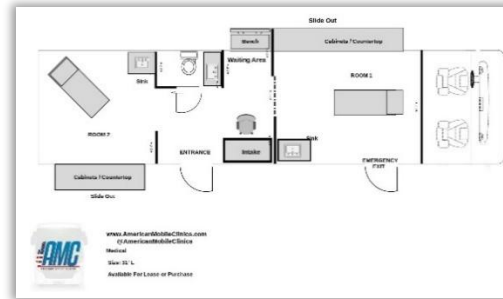

General Vehicle Specifications

- **Chassis: 2016 THOR ACE Ford FSeries Super Duty**
- **Engine: Ford Gasoline Triton V10 6.8L 362 HP @ 4750 RPM Torque 457' lbs @ 3250 RPM / Fuel capacity 80 gals**
- **GVWR: 18,000 lbs (no CDL required)**
- **Mileage: 62,110**
- **Generator: Cummins Onan 5500Kw / hours #220**
- **Transmission: TorqShift 5-speed automatic / overdrive / 4x2 driveline**
- **Exterior Measurements: 30.83'L x 8.25'W x 12.17'H (Interior 7'H)**
- **Wheelbase: 16' / steel composition / axles 1**
- **Tires: New late 2023 / 245/70R 19.5G (front & rear)**
- **Brakes: hydraulic disc (front & rear)**
- **Backup Camera**
- **Leveling Jack System: rear/front power adjustment**
- **Rear Hitch Receiver**
- **HVAC: roof-top mounted / 13,500 BTUs / heater automatic 35,000 BTUs**
- **Electrical: 110V / shore power 30Amps**
- **Drive Cab: (2) swivel captain chairs; power steering; cruise control; heated side mirrors; AM/FM; overhead storage**
- **(1) Custom Built Main Entrance Door: passenger side / tinted window / exterior light & grab bar**
- **(1) Emergency Exit Door: off front exam room / exterior light & grab bar**
- **Main Awning: entrance side 14'L power retractable**
- **Windows: tinted with mini blinds**
- **Ample undercarriage storage**
- **(2) Slide-outs: power retractable**

Interior Clinic Floor Plan

- **(2) Private Dental Operatories; chairs/lights; ProCarts; U/L cabinets & countertops; stainless steel sinks**
- **Lab Area + Intake Area & Waiting Area: staff desk / patient bench seating & TV / refrigerator**
- **Bathroom: toilet; cabinet w/stainless steel sink / ceiling vent**
- **Holding Water Tanks: fresh 50 gal/grey 44 gal/black 24 gal / propane 21 gal 88 lbs / water heater 6 gal electrical bypass**
- **Flooring: commercial-grade vinyl; storm gray color**
- **Interior Walls: white Formica easy-clean; all wall edging**
- **Lighting: 110V power cable/wire throughout clinic; recessed ceiling LED lights**
- **Features: ample storage; smoke & CO2 detectors & fire extinguisher**